

SA - KERB AND GUTTER

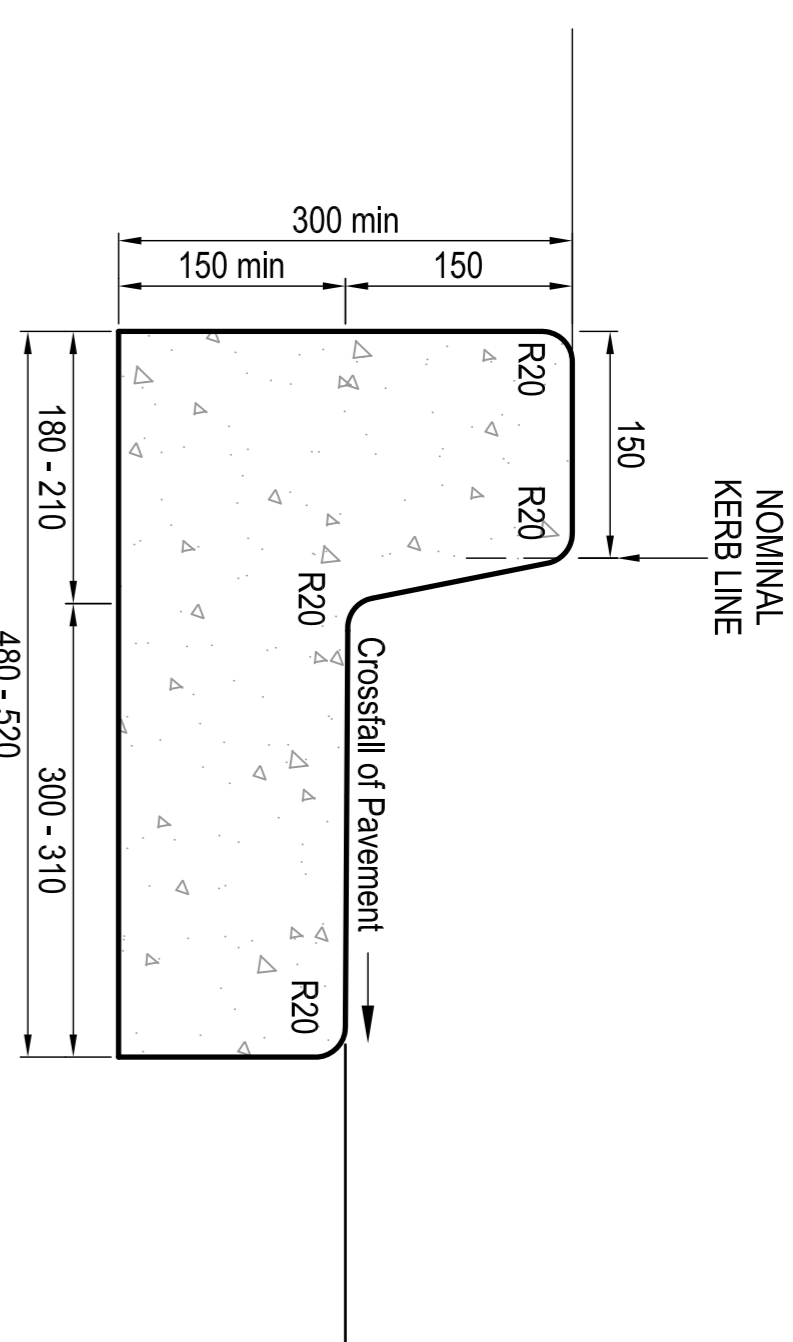

SL - BARRIER KERB

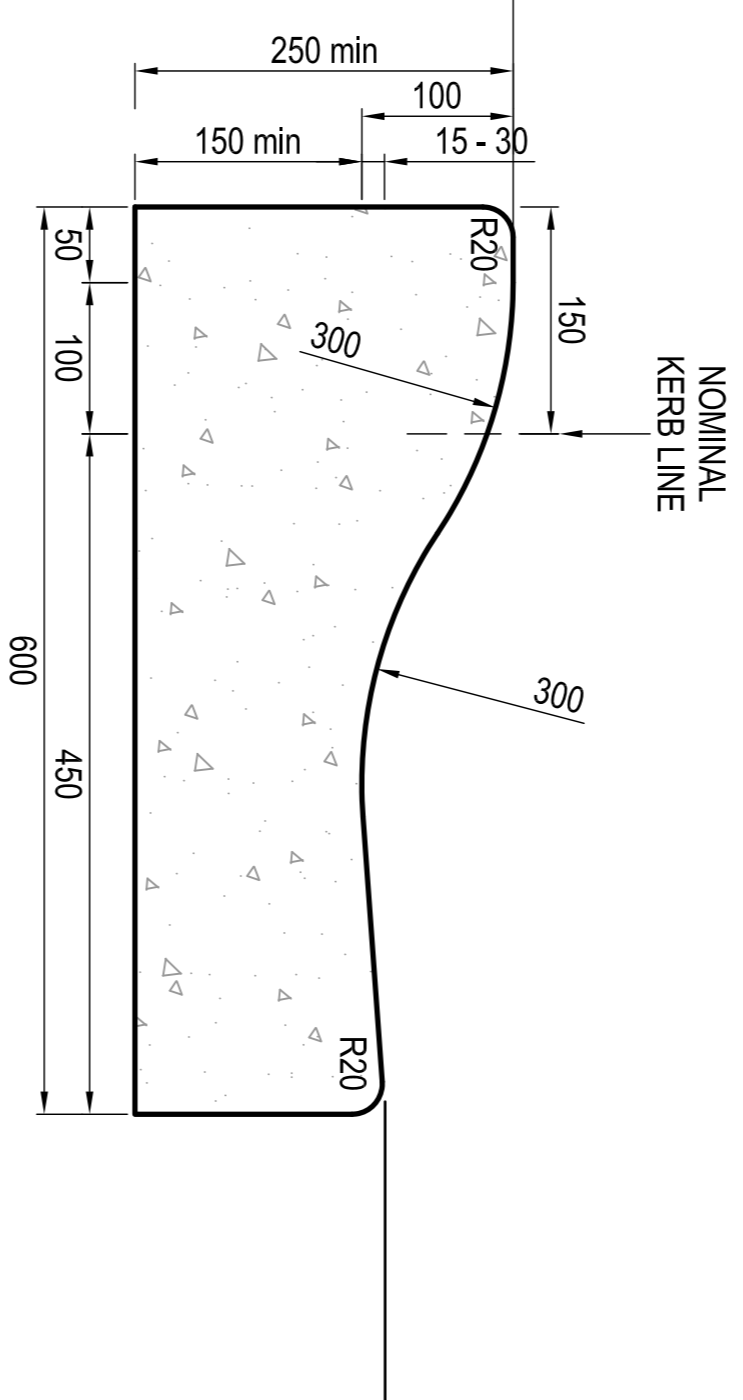

RT - ROLL TOP KERB AND GUTTER

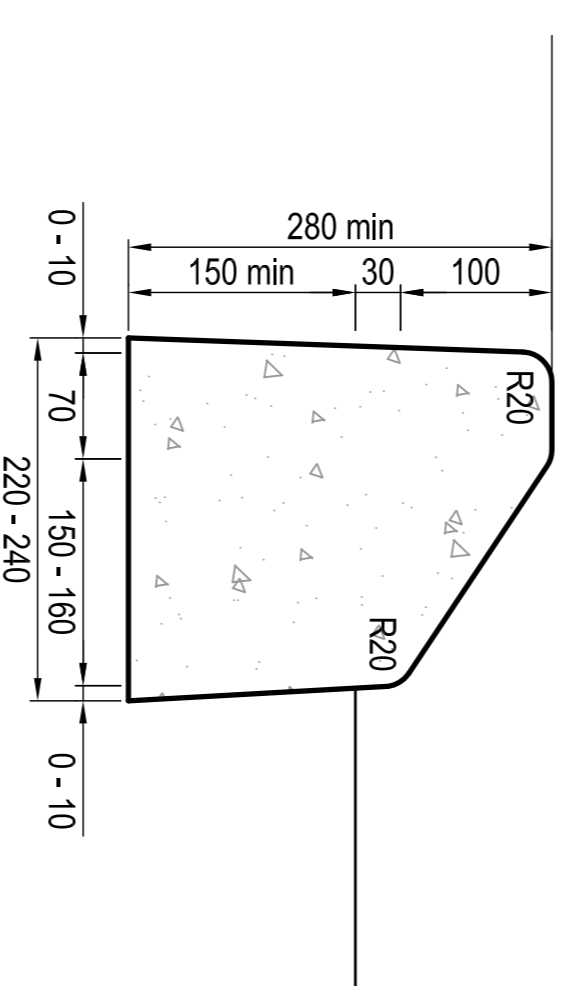

SF - MOUNTABLE KERB

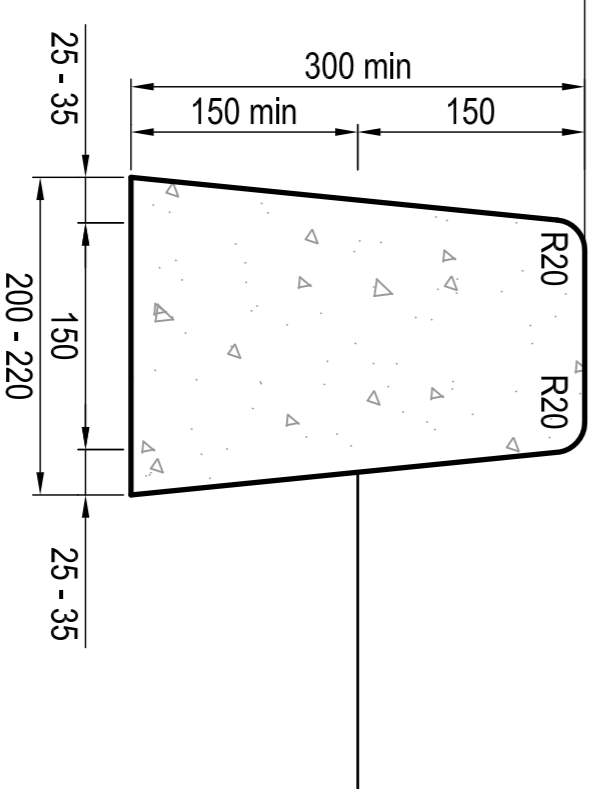

SM - BARRIER KERB

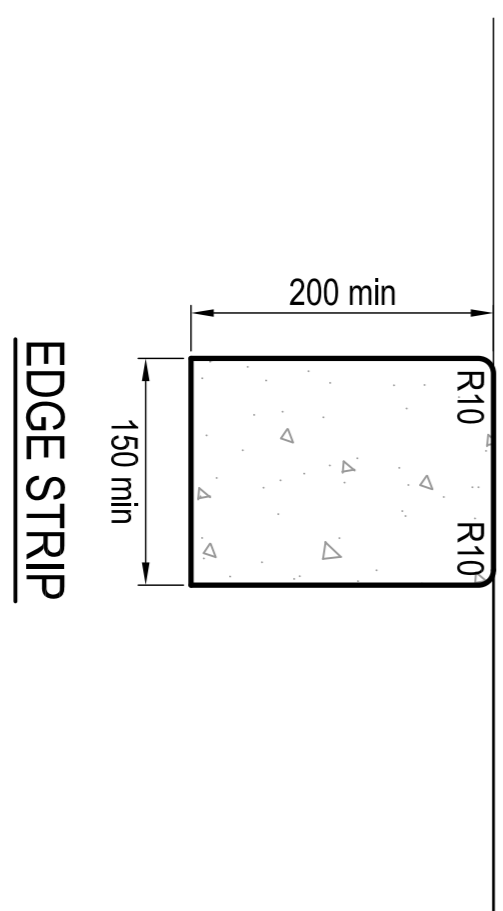

EDGE STRIP

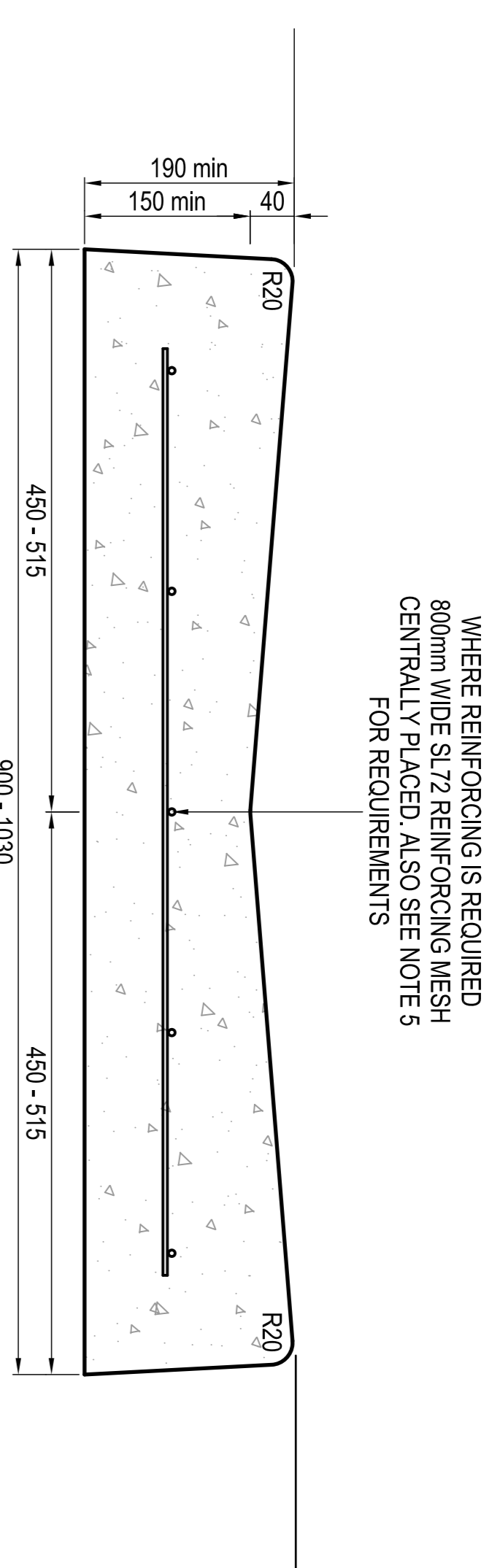

SB - DISH CROSSING

WHERE REINFORCING IS REQUIRED  
800mm WIDE SL72 REINFORCING MESH  
CENTRALLY PLACED. ALSO SEE NOTE 5  
FOR REQUIREMENTS

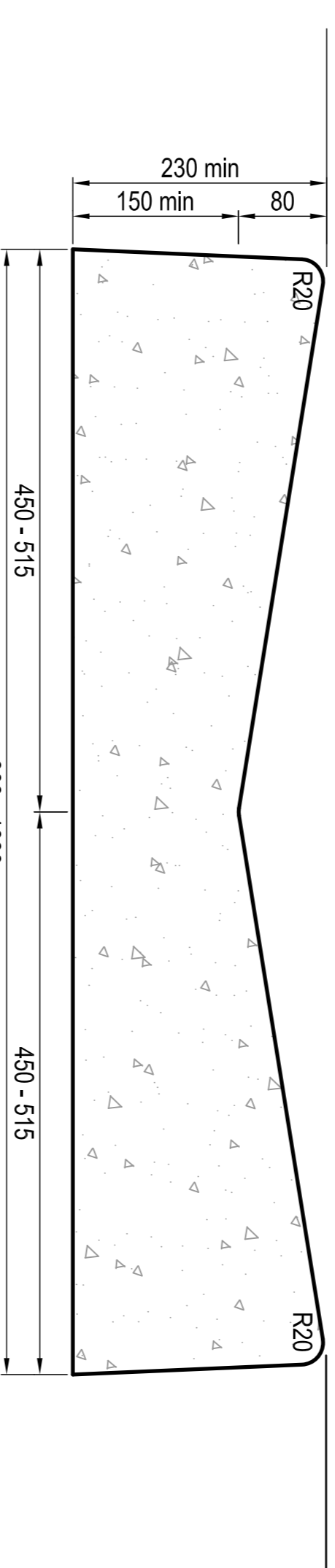

SC - DISH CROSSING

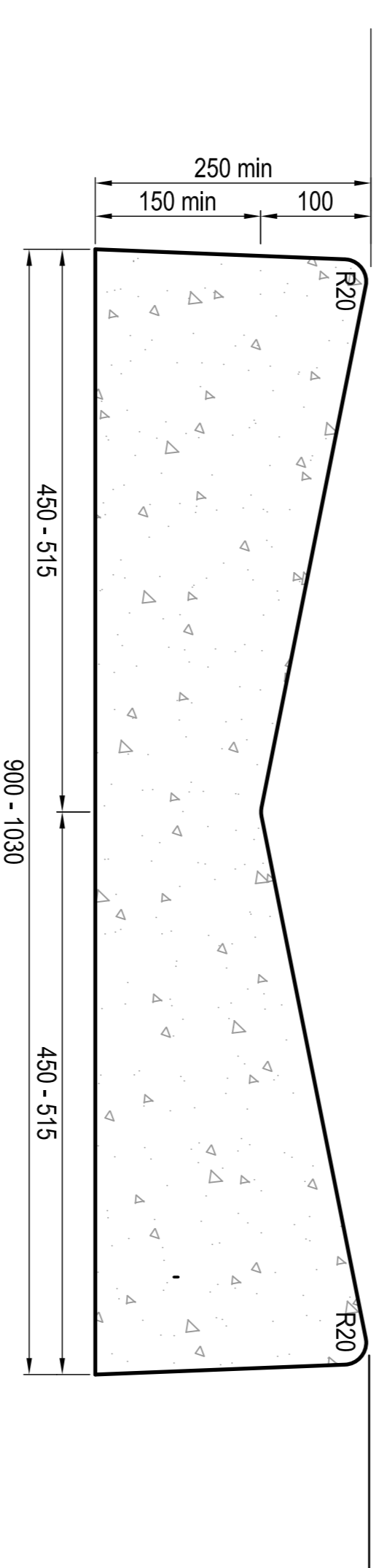

SO - DISH CROSSING

**NOTES**

1. All kerb profiles and dish drains shall be constructed in accordance with MCC Construction Specification 1121 Open Drains including Kerb and Gutter
2. Concrete shall have a 28 day compressive strength of 25 MPa adjacent to a flexible or 32 MPa adjacent to a rigid road pavement
3. All edges shall be shaped with an edging tool to the radii shown
4. Kerbs shown are MCC preferred profiles and dimensions. Any alternative kerb profiles shall require the approval of MCC prior to their use
5. SL72 reinforcement mesh shall be required in the SB dish crossing profile when dish crossing is likely to be subject to vehicle loading in road pavement or parking area. Reinforcement is to be centrally located with minimum and maximum cover to edges is 50 mm and 100 mm respectively. End laps shall be a minimum of 425 mm in length. Reinforcing may be required on SC and SO dish drains should they be impacted by traffic loads.
6. Should dish drains be installed in Industrial Driveways they should conform to SD0101

Rev.	Date	Description	Drawn	Checked	Approved on Behalf of Midcoast Council	Part Details	Sheet No.	Revision
B	1/07/19	Reo added to SO profile - Mountable Kerb profiles removed	AJC	AJC		STANDARD DRAWING	1	B
A	17/05/18	Issued for construction	AJC	GC 9/07/2019		KERB AND GUTTER AND DISH CROSSING PROFILES	No. of Sheets	Standard Dwg No.
						TYPICAL SECTIONS AND NOTES	1	SD0107



Drawn: AJC  
Checked: GC 9/07/2019

Approved on Behalf of Midcoast Council

STANDARD DRAWING  
KERB AND GUTTER AND DISH CROSSING PROFILES  
TYPICAL SECTIONS AND NOTES